

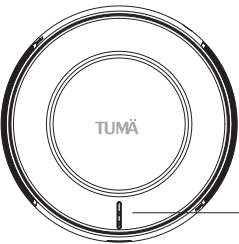

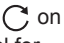

PRODUCT INSTRUCTIONS

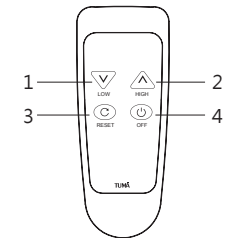

- Indicators on panel**
- No signal : Device off.
- Blue : High-speed air exchange.
- Orange : Low-speed air exchange.
- Red : When ON, replace the mesh. After it is replaced, press the button  on the remote control for 3 seconds for a reset.



- Buttons on the Remote Control**
- 1  LOW
- 2  HIGH
- 3  RESET
- 4  OFF

※ If you don't use the device for a long time, please take out the batteries.

SPECIFICATIONS

Voltage (V)	100-240	
Frequency (Hz)	50-60	
Speed	High	Low
Power Consumption (W)	2.7	1.9
Air Flow (m ³ /h)	34	24.3
Noise (dB(A)@1M)	32	27
Heat Recovery Efficiency (%)	40	42

Note : Design and specifications subject to change without notice.

DIMENSIONS

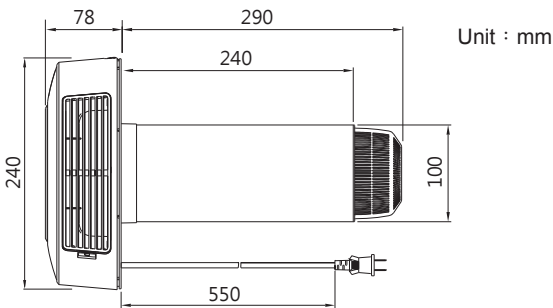

Model : AHR10E24-01 , 21~24cm thickwall

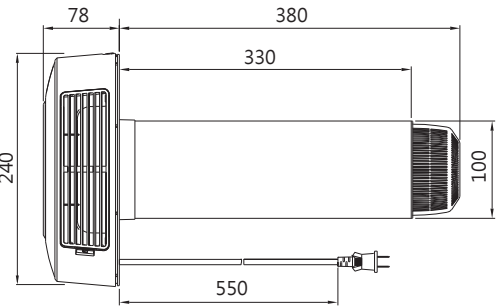

Model : AHR10E33-01 , 30~33cm thickwall

Flow2 One Main Unit

- Accessories :
- Nut - 3pcs
 - PM2.5 Filter - 5pcs/box
 - Paper Mold - 1pcs
 - Double End Screw (Ø6x45mm) - 3pcs
 - Yellow Plastic anchor (Ø9.5x31mm) - 3pcs

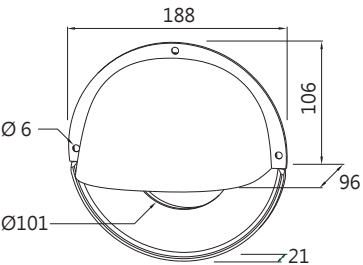

Aluminium Protection Cowl

- Accessories :
- Screw(Ø4x27mm) - 4pcs
 - Plastic anchor (Ø5x25mm) - 4pcs



Remote Control Included

- Accessories :
- AAA Battery - 2pcs



Flow2 One-AHR Ventilation Fan
Installation and Operating Instructions

- Model : AHR10E24-01 , 21~24cm thickwall
- Model : AHR10E33-01 , 30~33cm thickwall

Measuring of wall thickness shall include the thickness of decorations, like stone material, tiles, etc., inside and outside the wall.

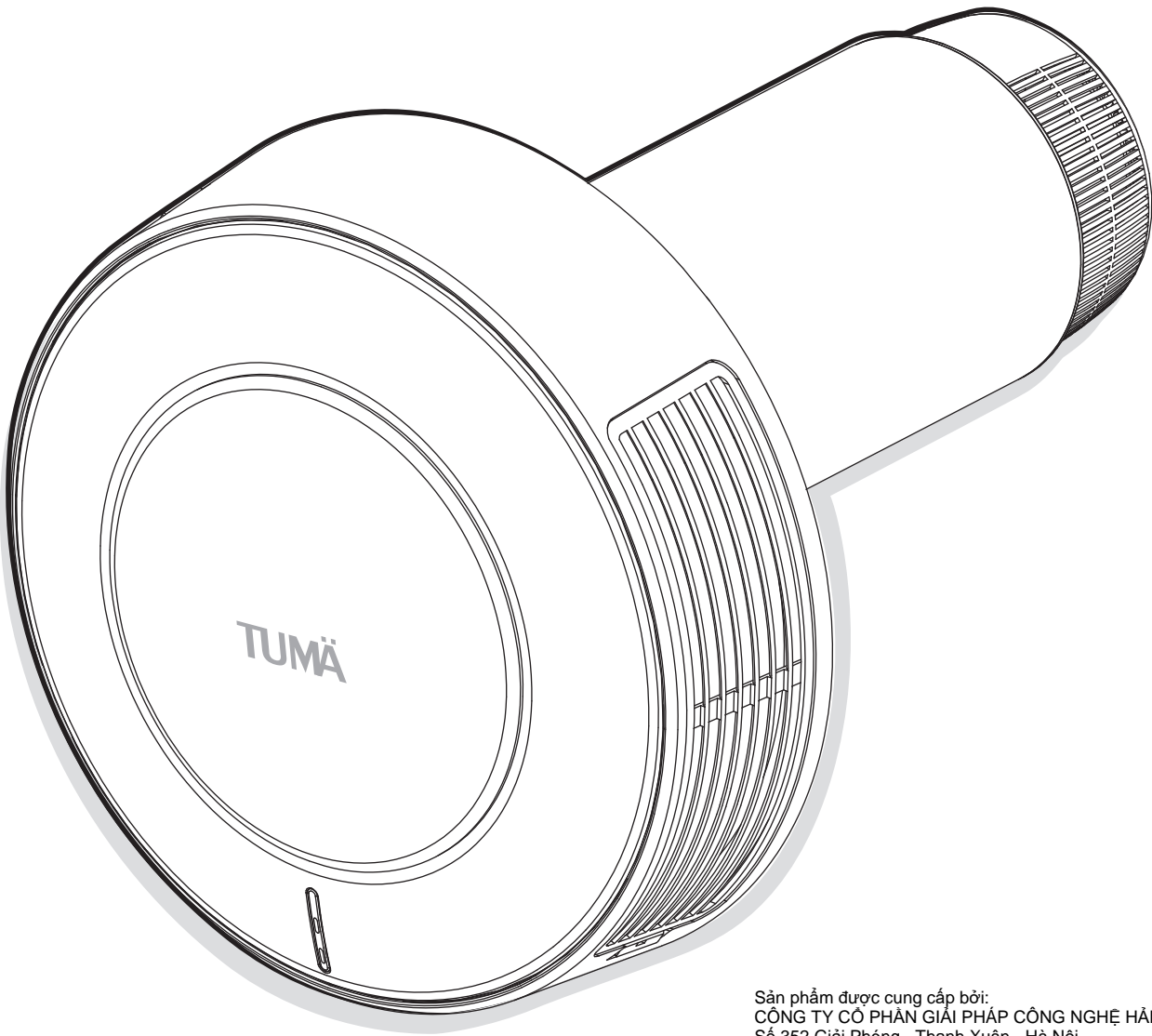

CAUTION

- 1 Short Circuit or Electric Shock Hazard:
- Do not mount in places with excessive moisture.

- Do not install the product near the shower room or above the bath tub in the bathroom or near places where it gets wet or immersed in water easily.

- Do not spray water directly on this device.
- 2 Possible damage:
- Do not mount over heating sources such as cooking equipment (see Fig. A), or in places with temperatures over 40°C. Do not mount on windows, thin plates or in places with insufficient support strength.

- When carrying the product, hold the tube part. (Fig. B)

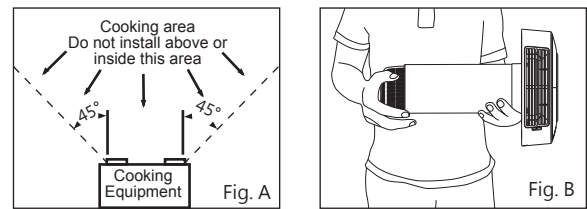

- 3 Possible damage or fire :
- Do not use power sources outside the rated voltage.

4 Do not use alternative mounting methods other than what is instructed in this manual.
- 5 Risk of Electric Shock Due to Inadequate Wiring :
- Any alteration to the internal wiring in this device is not allowed. In case of failure, please contact the service station.

- If the power cord is damaged, it must be replaced by the manufacturer, the manufacturer's service station, or a qualified person to avoid danger.
- 6 To Prevent Accidents :
- The bottom of the unit must be installed 2.3 meters or more above the ground.

- No water pipes are allowed to pass through above the product and 2 m around it.

- In case of gas leakage, Do Not turn on this device.

- This device shall not be operated or maintained by children or inexperienced individuals.
- 7 This device must not be mounted in places with peculiar smell or hazardous gas to prevent undesirable gas from flowing backwards into the room.
- 8 The outdoor part of the device must be mounted with the provided accessory: rain hood.



Do not dispose of electrical appliances as unsorted municipal waste, use separate collection facilities. Contact your local government for information regarding the collection systems available. If electrical appliances are disposed of in landfills or dumps, hazardous substances can leak into the groundwater and get into the food chain, damaging your health and well-being. When replacing old appliances with new ones, the retailer is legally obligated to take back your old appliance for disposal at least for free of charge.

INSTALLATIONS

- 1 Take out the paper mold from the box, draw an installation hole and screw holes on the wall as the below figure shows.
- ❗ The installation hole cannot be opened on crossbeams, pillars, or bearing walls. This will endanger the building's structure. It must also avoid electric wires inside the wall.

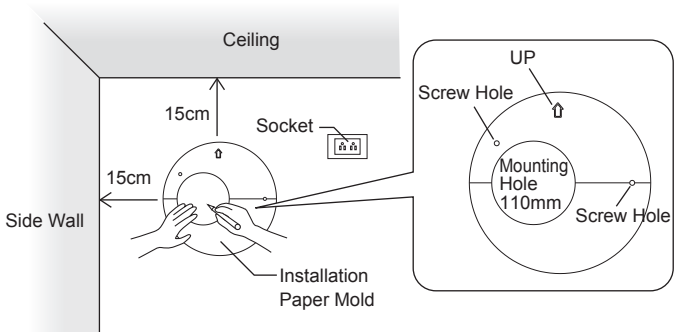

- A distance of 15 cm or more is required from the edge of the paper mold to the ceiling and each side of the wall.
- The socket needs to be within 30cm of the device, otherwise an extension cord is required.

- 2 Use a wall drill to open up a Ø110mm on the mounting hole position; and a Ø8mm, 35mm deep screw hole on the screw hole position.

❗ The direction of drilling shall be level to the ground.

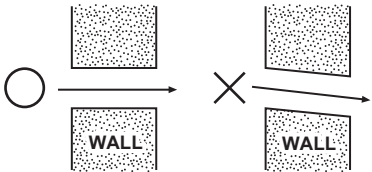

- 3 Drive the yellow plastic anchor into the screw hole position, then screw in the double end screw.

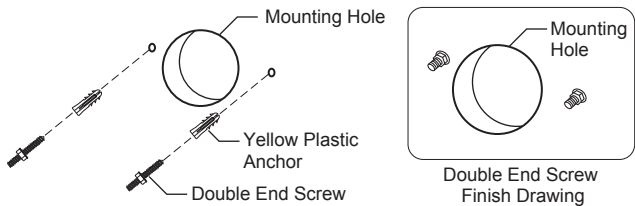

- 4-1 Take out the device from the box, and take down the screens on the left and right of the panel.
- 4-2 Put the round tube in the mounting hole.
- 4-3 Align it with the fixed double end screw on the wall, then hang it up.
- 4-4 Take a nut from the box and tighten it on the double end screw.

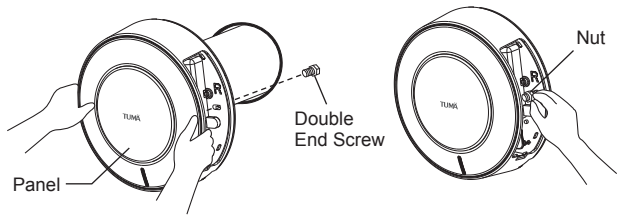

- 5 If mounted correctly, the duct tilts outdoors at a 1 degree angle.

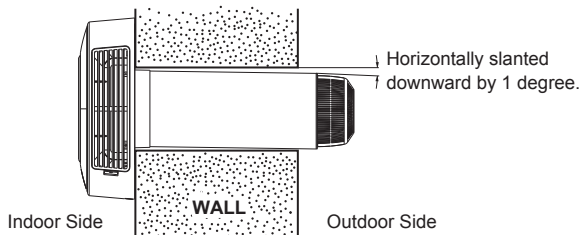

- 6 Put the screens back on. Attention: The left and right screens have different functions. Do not mount them on the wrong side. Put the internal exhaust mesh with an "R", along with the exhaust screen, in the buckle on the right side of the panel. And put the PM2.5 mesh in the buckle on the left side of the panel.

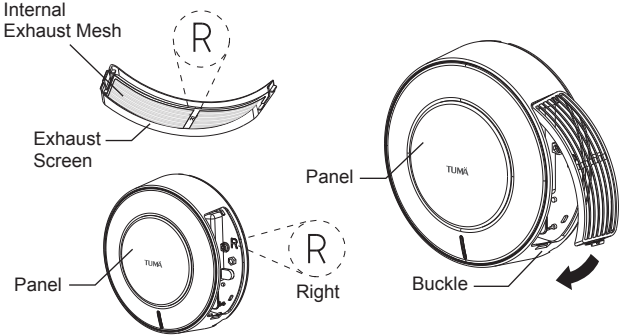

MOUNT THE RAIN HOOD

- 1 Mount the rain hood: take out the rain hood and slip it onto the bugler of the unit. Adjust the rain hood horizontally and centrally. Note positions of 3 screw holes on the wall as shown in the figure.

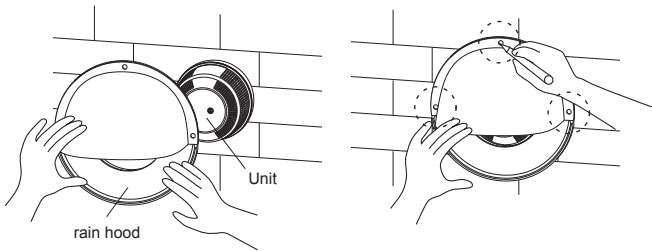

- 2 Take down the rain cover. Ream a Ø6mm, 30mm or more deep hole on the screw hole position, then drive in a white plastic anchor. (see Fig.C)
- 3 Enclose the rain hood again and align with the screw holes. Fix it on the anchor with the provided screws. (see Fig.D)

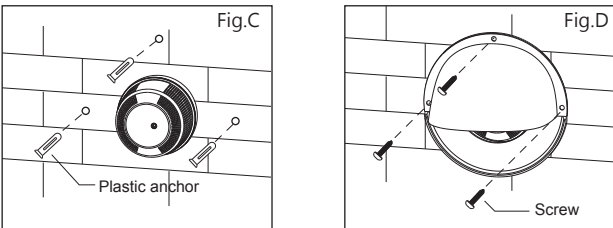

- 4 Seal up along the edge of the rain hood with waterproof material to prevent rainwater from seeping in.

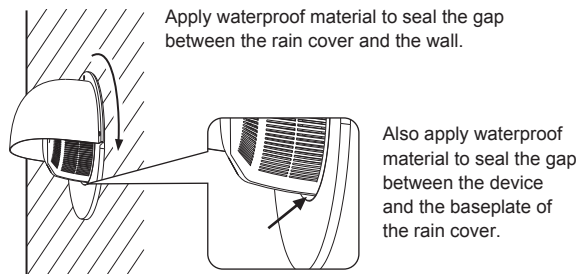

CLEANING

Caution

- Turn the power off before cleaning or maintaining the product.
- Do not switch the left and right filters on the unit. Filter malfunction will occur.

Left Panel : External Air Inlet Filter (Disposable PM2.5 filter)

- 1 If the panel indicator light shows RED, replace the PM2.5 filter.
- 2 Take off the air outlet grille from the left panel. After replacing the filter, restore the panel. On the remote control, press the RESET key.

Right Panel : Internal Air Outlet Filter (Washable filter)

- 1 Clean the filter once every two months is recommended.
- 2 Take off the air outlet grille from the right panel. Wash the filter with water. Wait until the filter is completely dry then place it back in the unit. Restore the panel.

Instructions Download : www.sunon.com

■ SUNONWEALTH ELECTRIC MACHINE INDUSTRY CO.,LTD. ■